



5601 BUILDING

VILLA DE REYES, SAN LUIS POTOSI
SAN LUIS POTOSI, S.L.P.



[clic / scan](#)
for location



Available for lease
60,331 FT² / 5,605 M²

Building Overview

Total Building Size
60,331 FT² / 5,605 M²

Office Space
2,195 FT² / 204 M²

Guard House
Yes, 402.16 FT² / 37.37 M²

Floor
6" Reinforced Concrete Floor Slab

Fire Protection System
Hose & Cabinets Smoke Detectors

Divisible
No

Clear Height
39 FT / 12 M

Skylights
8%

Loadings Docks
8

Access Ramp
1

Parking Spaces
18 Spaces

Electrical Substation
75 KVAs Transformer, Emergency
Power Plant

Lighting
Metal Halide

Wall Type
Block & Metal Sheet

Ventilation
To Suit

Layout

Offices

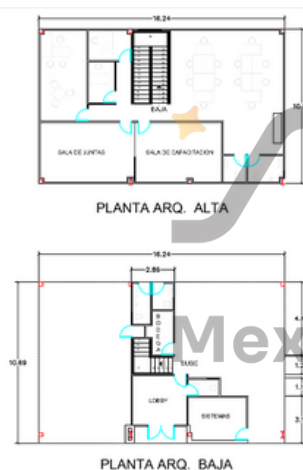

Cafeteria

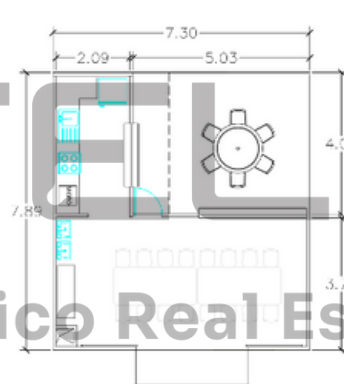

Cafeteria

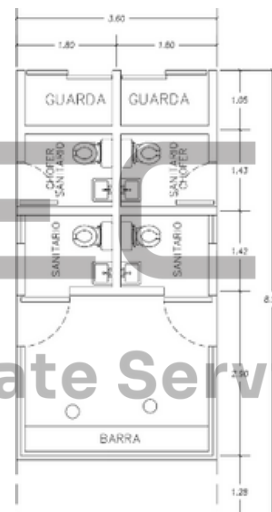

Warehouse

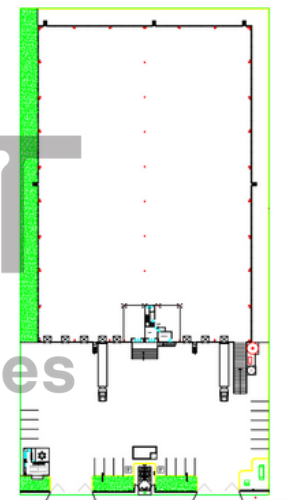



5601 BUILDING
 VILLA DE REYES, SAN LUIS POTOSI
 SAN LUIS POTOSI, S.L.P.



Corporate Neighbors



Pictures



SELECT
 Mexico Real Estate Services

JUAN PABLO NAVA +52 (444) 803 8679

juan.nava@select-rs.com

US Phone: +1 (833) 227 7922
 Mx Number: +52 (899) 929 3830

www.select-rs.com

